

### DESCRIPTION

Intercept V-Trac is a modular metal panel with concealed fastener attachment for exterior walls and soffits. Extruded clips are shop attached to the top of the panel, resulting in a panel that is independently suspended from the top. A unique gullwing carrier track extrusion is incorporated into the vertical joint. Panels are 1-1/2" deep and available in .060" thick aluminum or 1.5mm zinc finishes. Standard vertical and horizontal panel joint reveals are 3/4" wide. Intercept V-Trac panels may be installed in a variety of rainscreen applications to form a complete exterior wall system. System designs may vary from an uninsulated screen wall to Intercept V-Trac with MetalWrap™ Series, an insulated composite backup panel system. Pre-finished aluminum Intercept V-Trac panels are available with a 20-year standard finish warranty.

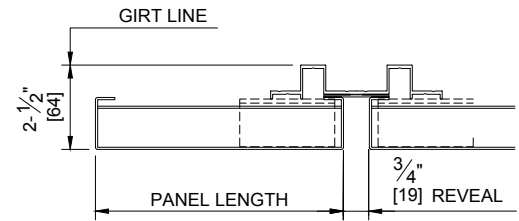

### End Joint

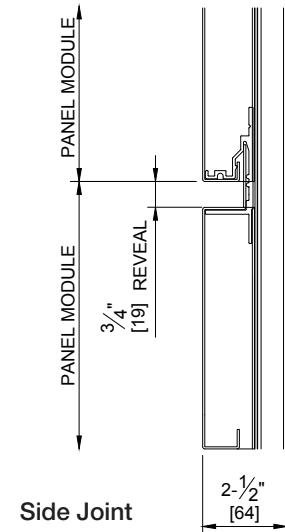

### GENERAL DESIGN OPTIONS

	0.060" ALUMINUM	1.5mm ZINC
MAXIMUM PANEL MODULE <sup>1</sup>	42" [1.1m]	32" [0.81m]
MAXIMUM PANEL LENGTH <sup>1</sup>	138" [3.5m]	64" [1.62m]
PANEL REVEAL WIDTH	3/4" [19mm]	3/4" [19mm]
PANEL SHAPES <sup>2</sup>	Square or Rectangle	Square or Rectangle
PANEL DEPTH	1-1/2" [35mm]	1-1/2" [35mm]
STANDARD SYSTEM DEPTH	2-1/2" [63.5mm]	2-1/2" [63.5mm]
STANDARD TEXTURE	Smooth	Natural
WEIGHT <sup>4</sup>	Approx. 1.5 lb. / sf.	Approx. 3.0 lb. / sf.
FINISHES <sup>3</sup>	Allura™, Celestial™ Effects, Duragard®, Duragard® Plus, Fluorofinish®, Impressions®, Kolorshift™, Sundance™ AM and Sundance™ Mica	See ZINC flyer for color options

- Contact CENTRIA for larger sizes. Overall panel size is aspect dependent.  
Maximum panel module and length cannot be combined on the same panel.
- Additional panel applications available, contact CENTRIA.
- Random direction, panel to panel variation expected.
- Approximate weights were calculated based on a 24" x 36" panel. Actual weights may vary.

### NOTES

- For more information contact your local CENTRIA Sales Representative.
- All Intercept V-Trac panels may be used for interior or exterior walls and soffits.
- Panel Dimension Tolerance +/- 1/16".

INTERCEPT V-TRAC  
 RECOMMENDED MAXIMUM PANEL SIZES

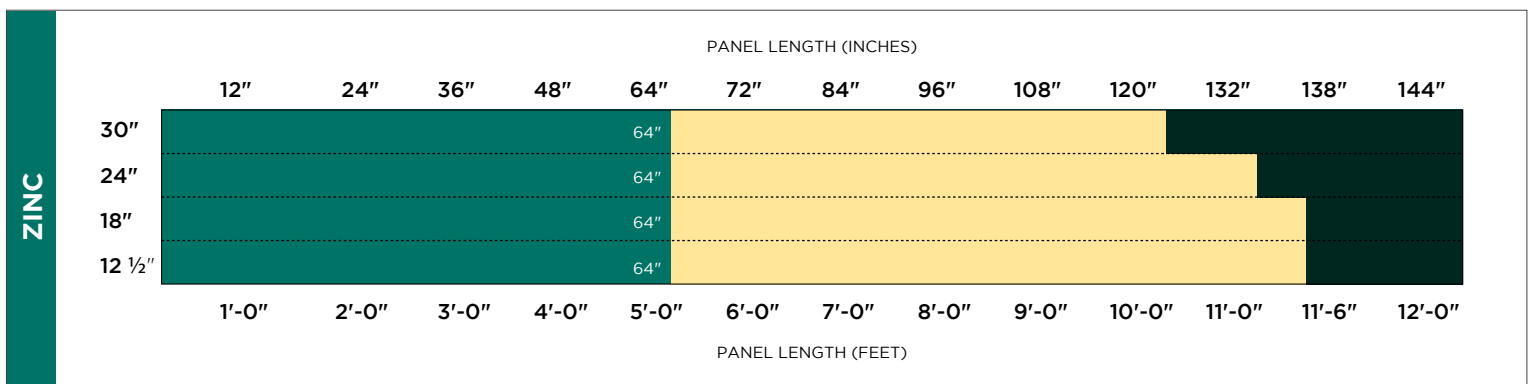
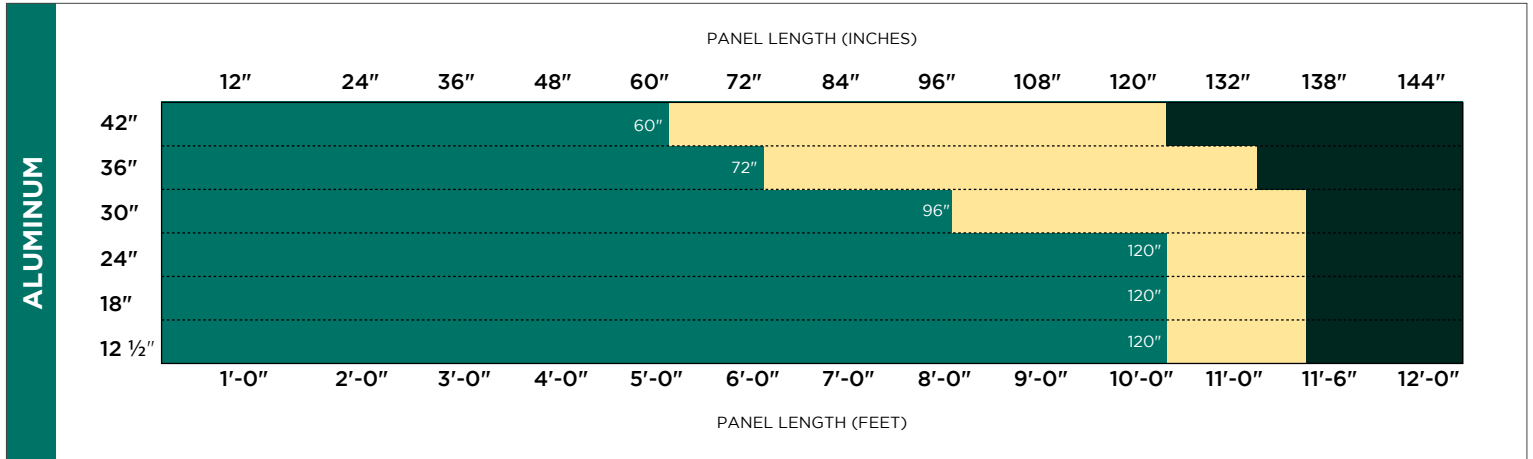

- RECOMMENDED MAXIMUM PANEL DIMENSIONS
- CONTACT CENTRIA FOR GUIDANCE
- EXCEEDS SIZE LIMITS

- V-TRAC PANEL DEPTH = 1 1/2"
- V-TRAC SYSTEM DEPTH = 2 1/2"
- V-TRAC SYSTEM MINIMUM RADIUS = 6'-0" (CONCAVE OR CONVEX)
- V-TRAC SYSTEM MAXIMUM RADIUS = NONE (CONCAVE OR CONVEX)